

### Mounting T3 Plus on the base

Lower the tablet onto the base. You should feel a magnetic click once the tablet is seated properly. LED status turns from red to blue.

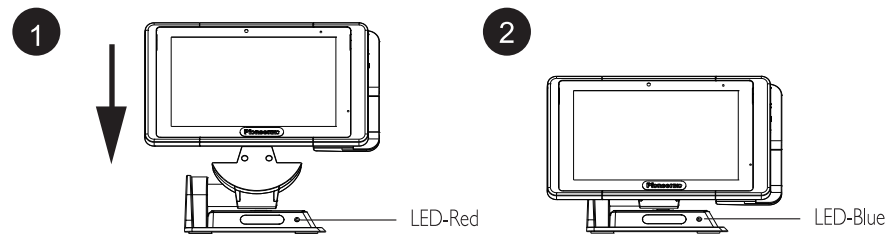

### Removing from the base

To easily remove the the tanlet from the base, grip the handle and pull up the tablet. LED status turns from blue to red.

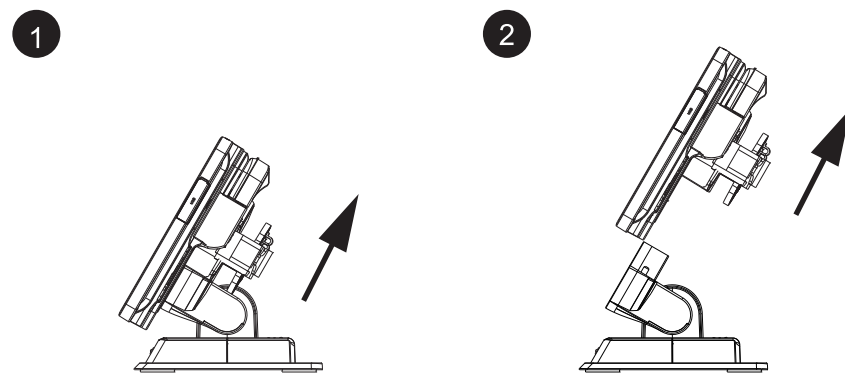

Please visit us at [www.pioneersolution.com](http://www.pioneersolution.com)

For product support:  
 US & Canada: [support@pioneersolution.com](mailto:support@pioneersolution.com),  
 or call 909-468-9757, option 2  
 Others: [support@evensystems.com](mailto:support@evensystems.com)

### Packing Contents

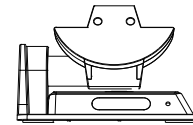

1 x Low Profile Base



3 x Screws

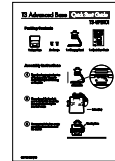

1 x Quick Start Guide

### Front View

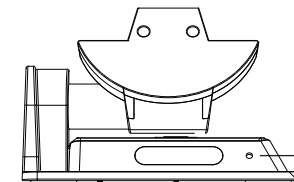

LED Status

- Off (No Power)
- Red (Standby/Tablet disconnect)
- Blue (Charging/Tablet connect)

### Back View

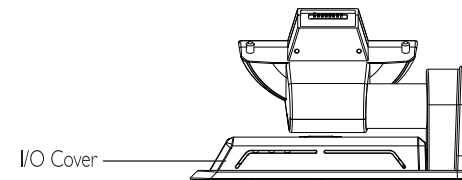

I/O Cover

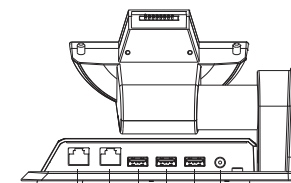

RS232 USB 2.0 DC In